

FACILITY
GUIDE

ICCJEJU

A business trip
becomes a surprise holiday at

ICCJEJU

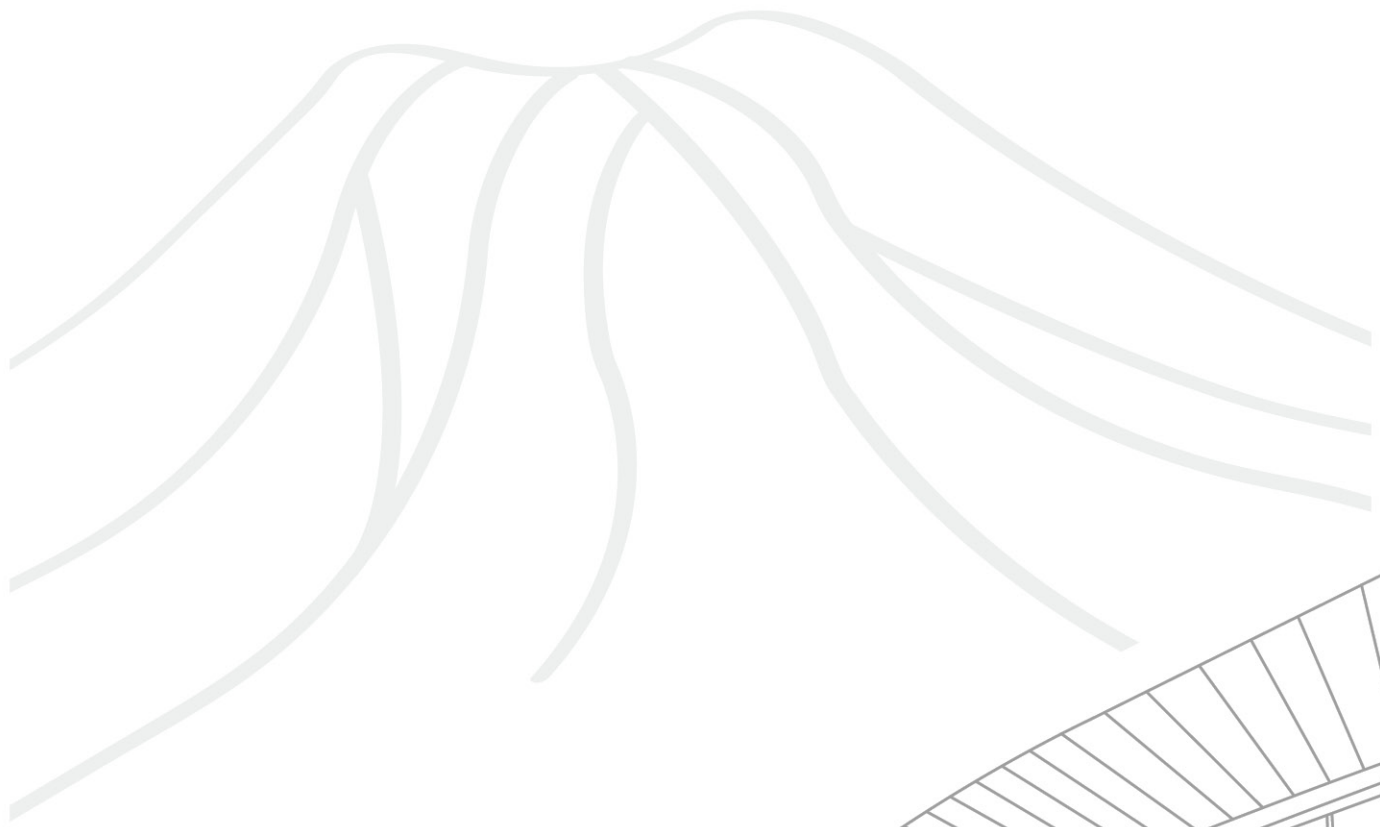
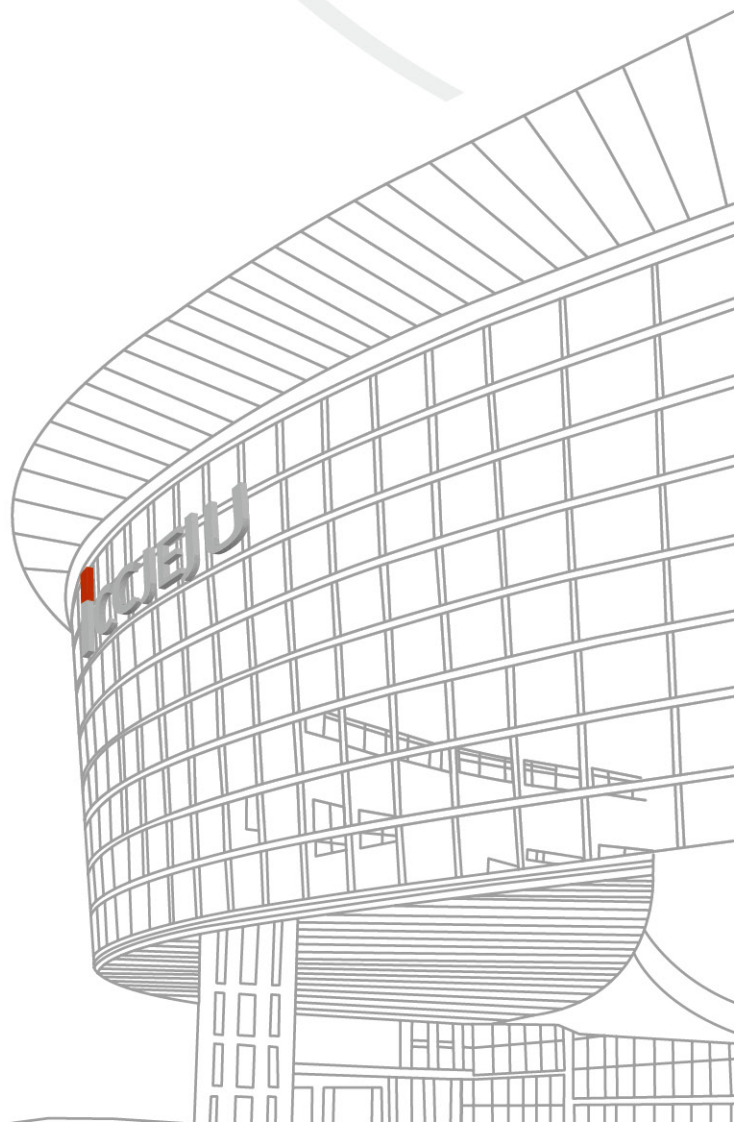

ICC JEJU OVERVIEW

FLOOR PLANS

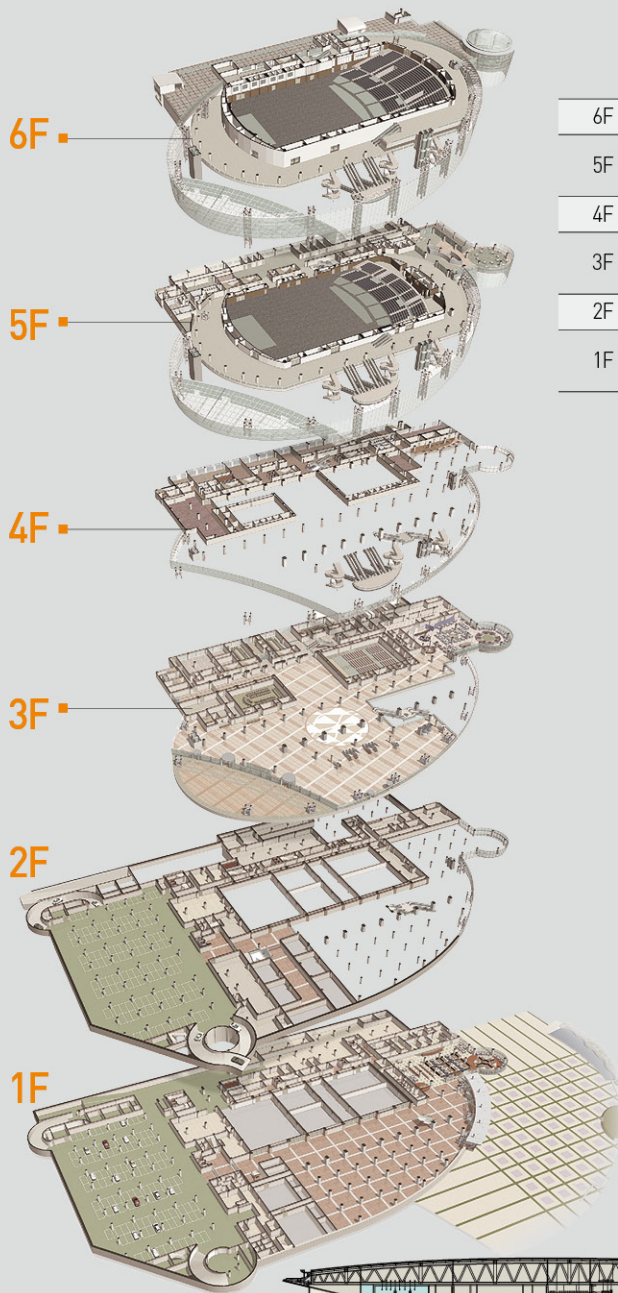

6F	Tamna Hall, Foyer, Roof Garden
5F	Tamna Hall, Foyer, Ocean View, Waiting Room (501 ~ 507)
4F	Small Meeting Room (400, 401, 402), Deli View
3F	Lobby, Halla Hall, Samda Hall, Delizia Restaurant, Small Meeting Room (300, 301, 302, 303, 304)
2F	Small Meeting Room (201, 202, 203)
1F	Event Hall (Event Hall A, Yeongju Hall, Baeknok Hall), leodo Plaza

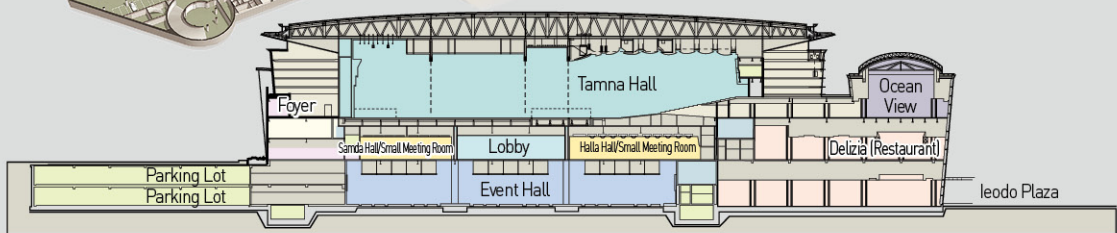

CONVENTION & EXHIBITION

A Global Convention Center combines elegance and functionality

ICC JEJU features world-class convention facilities in quality as well as in functionality.

Its grand-scale convention hall and conference rooms coming in all sizes are perfectly adapted to all your gathering needs, including international summit meetings, medium to small-size conferences and assemblies, and events of all types. Each and every conference space and event hall is fully equipped to meet all logistic requirements, ranging from cutting-edge simultaneous interpreting system to AV system, trench system and more.

Auxiliary facilities such as its restaurant, convenience store and duty free shop are convenient and pleasurable additions to your experience at ICC JEJU. We are fully prepared to host your success. Carry the day in the splendid setting of ICC JEJU.

	Type	Floor Area		Room Area/Dimension (m)	Capacity (person)		
		Area(m ²)	Area(m ²)	Width X Length X Height (m)	Theater	Banquet	Classroom
Tamna Hall	A+B+C	4,597	4,061	80.4 x 45.4 x 13.7	4,300	2,000	3,500
	A	2,581	2,294	45.2 x 45.4 x 13.7	1,500	—	1,500
	B+C	2,016	1,768	35.0 x 45.4 x 13.7	2,800	1,100	2,000
Halla Hall	A+B	812	643	29.9 x 21.5 x 4.95	660	350	500
	A	424	350	16.2 x 21.5 x 4.95	360	190	270
	B	388	293	13.5 x 21.5 x 4.95	300	160	230
Yeongju Hall	A+B	881	831	25.8 x 32.2 x 6.6	750	450	560
	A	441	403	25.8 x 15.6 x 6.6	360	220	320
	B	440	428	25.8 x 16.6 x 6.6	390	230	340
Baeknok Hall	A+B	638	596	18.5 x 32.2 x 6.6	500	300	420
	A	319	289	18.5 x 15.6 x 6.6	240	140	200
	B	319	307	18.5 x 16.6 x 6.6	260	160	220
Samda Hall	A+B	398	276	20.9 x 13.2 x 5.2	300	180	200
	A	197	136	10.5 x 13.2 x 5.2	150	90	100
	B	201	140	10.2 x 13.2 x 5.2	150	90	100
Small Meeting Room	201	266	234	8.7 x 26.9 x 3.3	200	100	150
	201 A	138	120	8.7 x 13.8 x 3.3	100	50	75
	201 B	128	114	8.7 x 13.1 x 3.3	100	50	75
	202	268	237	9.5 x 25.5 x 3.3	200	100	150
	202 A	134	117	9.5 x 12.8 x 3.3	100	50	75
	202 B	134	120	9.5 x 12.7 x 3.3	100	50	75
	203	199	174	9.5 x 18.5 x 3.3	150	80	100
	300	80	78	7.5 x 10.4 x 3.0	90	40	50
	301	113	109	7.5 x 14.5 x 2.7	110	70	80
	301 A	57	55	7.5 x 7.2 x 2.7	55	35	40
	301 B	56	54	7.5 x 7.1 x 2.7	55	35	40
	302	113	109	7.5 x 14.5 x 2.7	110	70	80
	303	143	125	16.1 x 7.8 x 3.0	130	80	100
	303 A	69	62	7.9 x 7.8 x 3.0	65	40	50
	303 B	74	63	7.9 x 7.8 x 3.0	65	40	50
	304	61	56	7.5 x 7.8 x 3.0	60	40	45
	400	80	78	7.5 x 10.4 x 3.0	90	40	50
	401	141	128	16.2 x 7.9 x 3.0	130	80	100
	401 A	71	64	8.0 x 7.9 x 3.0	65	40	50
	401 B	70	64	8.0 x 7.9 x 3.0	65	40	50
402	216	194	24.70 x 7.9 x 3.0	200	120	150	
402 A	108	97	12.25 x 7.9 x 3.0	100	60	75	
402 B	108	97	12.25 x 7.9 x 3.0	100	60	75	
500	136	136	16.8 x 8.1 x 3.0	130	60	80	
Event Hall	A+B+C	2,503	2,395	75.55 x 31.8 x 6.1	2,450	1,510	1,830
	A	809	772	24.40 x 31.8 x 6.1	790	490	590
	B	847	811	25.20 x 31.8 x 6.1	830	510	620
	C	848	812	25.55 x 31.8 x 6.1	830	510	620

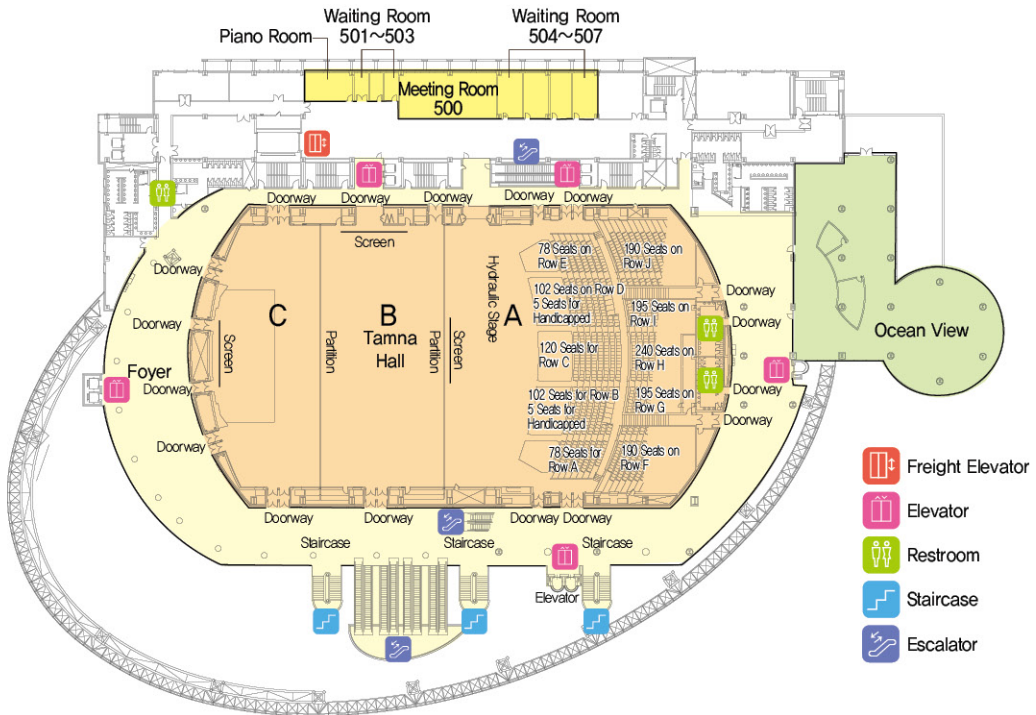

TAMNA HALL

- ▶ 4,300 persons (1,500 fixed seats and 2,800 theater style seats), dividable into 3 separate rooms
- ▶ **Major Functions** International conventions, Banquets, Performances, Sporting events, etc

Type	Area(m ²)	Width X Length X Height (m)	Theater	Banquet	Classroom
A+B+C	4,061	80.4 x 45.4 x 13.7	4,300	2,000	3,500
A	2,294	45.2 x 45.4 x 13.7	1,500	—	1,500
B+C	1,768	35.0 x 45.4 x 13.7	2,800	1,100	2,000

Specifications

- Beam projector (at Tamna A, 20,000 ANSI)
- Freight elevator: 6.2tons (W 3.7m X H 2.7m X D 7.4m)
- Simultaneous interpretation room (Tamna Hall: 16 rooms) / control room
Infrared ray wireless 8-language simultaneous interpretation system
- Electric screen
Tamna A 11m (horizontal)
Tamna B 5.5m (horizontal)
Tamna C 11m (horizontal)

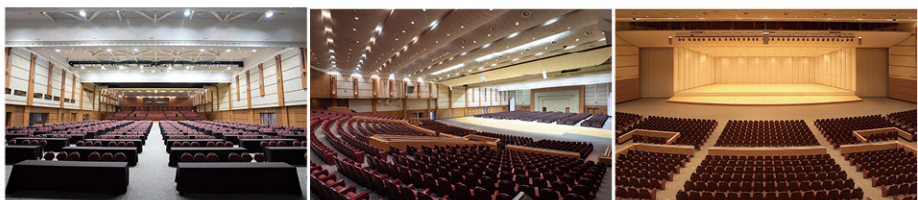
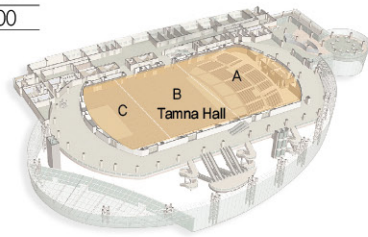

OCEAN VIEW

- ▶ Location 5th floor
- ▶ Major Functions Banquets, conferences, wedding ceremonies
- ▶ Capacity 956m², Banquet for 250 persons
- ▶ Menu Vary by prices

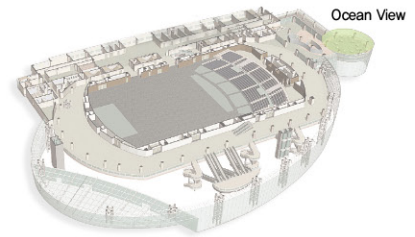

FOYER 5F,6F

- ▶ Location 5th, 6th floors
- ▶ Major Functions Coffee breaks, Exhibitions, Banquets
- ▶ Detail
 - For multipurpose such as cocktail party, exhibition, poster session, coffee break, etc.
 - The lobby for Tamna Hall, the large conference room, on the 5th floor to view beautiful Hallasan Mountain and blue sea through the large-scale curtain wall

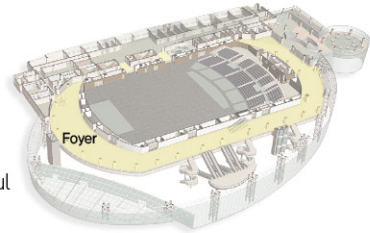

WAITING ROOM

- ▶ Location 5th Floor
- ▶ Major Functions Waiting rooms, Meeting room, Secretariat office
- ▶ Size
 - Room 500 136m²
 - Room 501 ~ 503 12m²
 - Room 504 ~ 507 35m²

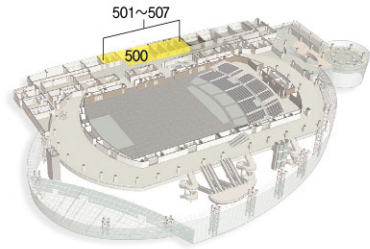

ROOF GARDEN

- ▶ Location 6th floor
- ▶ Major Functions Receptions, Standing buffets
- ▶ Standing reception for 100 - 150 persons

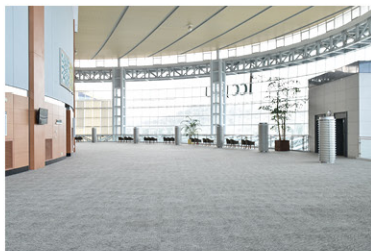
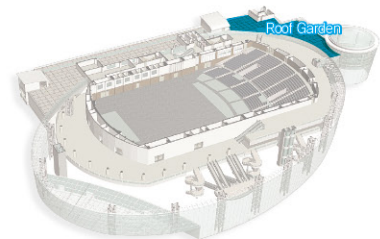

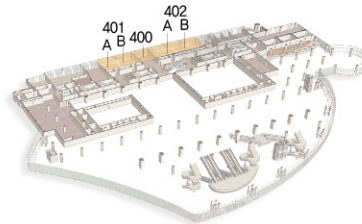
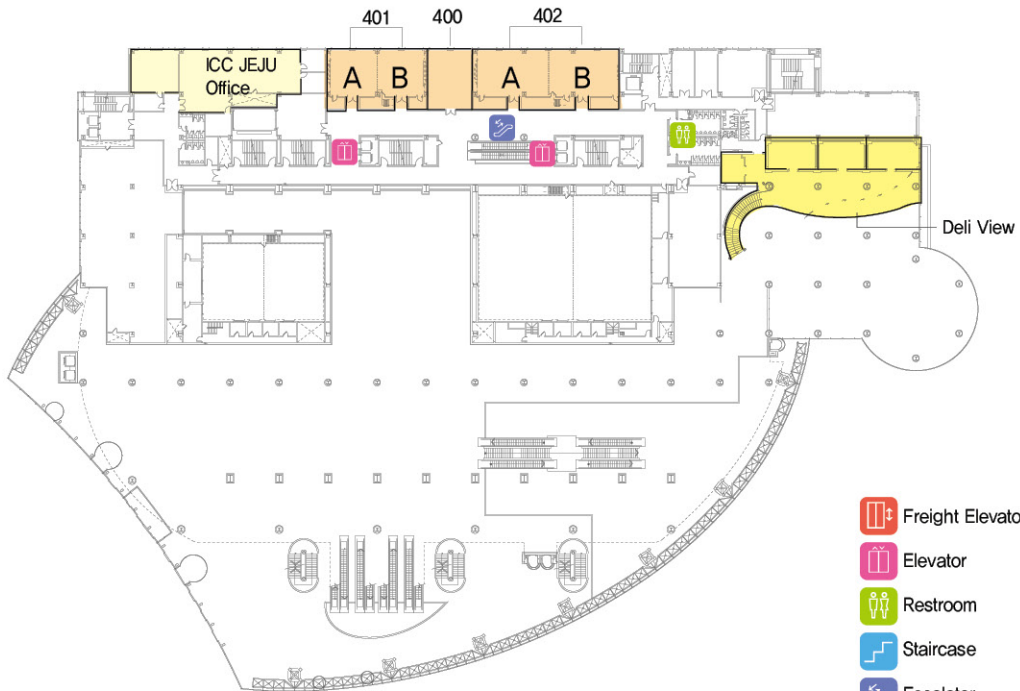

MEETING ROOM

▶ Meeting Room 400

Type	Area(m ²)	Width X Length X Height (m)	Theater	Banquet	Classroom
400	78	7.5 x 10.4 x 3.0	90	40	50

- Specifications
 - Audio system
 - Built - in screen (150")
 - Beam projector (portable)

▶ Meeting Room 401 (2 sections)

Type	Area(m ²)	Width X Length X Height (m)	Theater	Banquet	Classroom
A+B	128	16.20 x 7.9 x 3.0	130	80	100
A	64	8.0 x 7.9 x 3.0	65	40	50
B	64	8.0 x 7.9 x 3.0	65	40	50

- Specifications (401A)
 - Audio system
 - Built - in screen (180")
 - Beam projector (installed)
 - Banner size: 7.6m X 0.55m (magnet attachment)

- Specifications (401B)
 - Audio system
 - Built - in screen (150")
 - Beam projector (installed)
 - Banner size: 7.6m X 0.55m (magnet attachment)

▶ Meeting Room 402 (2 sections)

Type	Area(m ²)	Width X Length X Height (m)	Theater	Banquet	Classroom
A+B	194	24,70 x 7,9 x 3,0	200	120	150
A	97	12,25 x 7,9 x 3,0	100	60	75
B	97	12,25 x 7,9 x 3,0	100	60	75

· Specifications (402A)

- Audio system
- Built - in screen (180")
- Beam projector (installed)
- Banner size: 7.6m X 0.55m (magnet attachment)

· Specifications (402B)

- Audio system
- Built - in screen (150")
- Beam projector (installed)
- Banner size: 7.6m X 0.55m (magnet attachment)



DELI VIEW

- ▶ Location 4th floor
- ▶ Major Functions Small-sized banquets
- ▶ Menu Buffet, Western, Korean
- ▶ Seats 100
- ▶ Business Hours 11:00 ~ 15:00 (Lunch)
15:30 ~ 17:00 (Break Time)
17:00 ~ 21:00 (Dinner)
- ▶ Reservation and Contact +82-64-738-6400

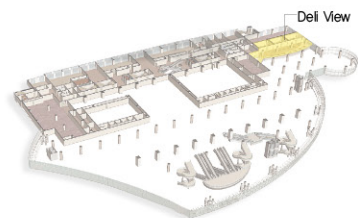

CONFERENCE ROOM, MEETING ROOM HALLA HALL, SAMDA HALL



HALLA HALL

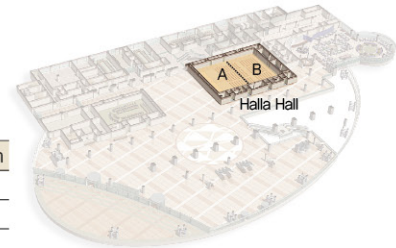

Type	Area(m ²)	Width X Length X Height (m)	Theater	Banquet	Classroom
A+B	643	29.9 x 21.5 x 4.95	660	350	500
A	350	16.2 x 21.5 x 4.95	360	190	270
B	293	13.5 x 21.5 x 4.95	300	160	230

Specifications

- Beam projector (Main, 10,000 ANSI)
For A/B sections, Elevated Beam projector 7,000 ANSI
- Four simultaneous interpretation rooms
- Infrared ray wireless 4-language simultaneous interpretation system
- Electric screen
Halla 12 m X 5 m
Halla A 5 m (horizontal)
Halla B 5 m (horizontal)
- Banner size: Halla Hall 10mx0.9m,
Halla A/Halla B 8.8mx0.9m
- Movable stage size: 9.6m X 4.8m (main)



SAMDA HALL

Type	Area(m ²)	Width X Length X Height (m)	Theater	Banquet	Classroom
A+B	276	20,9 x 13,2 x 5,2	300	180	200
A	136	10,5 x 13,2 x 5,2	150	90	100
B	140	10,2 x 13,2 x 5,2	150	90	100

Specifications

- Beam projector (Main, 10,000 ANSI)
For A/B sections, Elevated Beam projector 7,000 ANSI
- Four simultaneous interpretation rooms
- Infrared ray wireless 4-language simultaneous interpretation system
- Electric screen
Samda 9.5m X 3.5m
Samda A 5m (horizontal)
Samda B 5m (horizontal)
- Recommended banner size: if merged (10 m X 0.9 m), if divided (6.4 m X 0.9 m)
- Movable stage size: 9.6m X 4.8m (main)

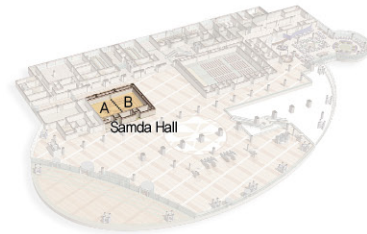

LOBBY & MEETING ROOM

Lobby

- Capacity : 60 exhibition booths (3m X 3m / booth)
- Major Functions : Registration and information desk, Exhibition booth, Poster sessions, Banquets

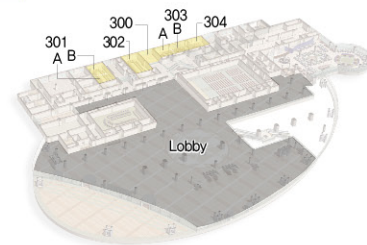

Meeting Room 300

Type	Area(m ²)	Width X Length X Height (m)	Theater	Banquet	Classroom
-	78	7,5 x 10,4 x 3,0	90	40	50

Specifications

- Audio system
- Built - in screen (150")
- Beam projector (portable)

Meeting Room 301 (2 sections)

Type	Area(m ²)	Width X Length X Height (m)	Theater	Banquet	Classroom
A+B	109	7,5 x 14,5 x 2,7	110	70	80
A	55	7,5 x 7,2 x 2,7	55	35	40
B	54	7,5 x 7,1 x 2,7	55	35	40

Specifications (301A)

- Audio system
- Built - in screen (150")
- Beam projector (portable)
- Banner size: 4.7m X 0.6m (magnet attachment)

Specifications (301B)

- Audio system
- Built - in screen (150")
- Beam projector (portable)
- Banner size: 4.7m X 0.6m (magnet attachment)

▶ Meeting Room 302

Type	Area(m ²)	Width X Length X Height (m)	Theater	Banquet	Classroom
302	109	7,5 x 14,5 x 2,7	110	70	80

· Specifications

- Audio system
- Built - in screen (150")
- Beam projector (portable)
- Banner size: 4.7 m X 0.6 m (magnet attachment)

▶ Meeting Room 303 (2 sections)

Type	Area(m ²)	Width X Length X Height (m)	Theater	Banquet	Classroom
A+B	125	16.1 x 7.8 x 3.0	130	80	100
A	62	7.9 x 7.8 x 3.0	65	40	50
B	63	7.9 x 7.8 x 3.0	65	40	50

· Specifications (303A)

- Audio system
- Built - in screen (150")
- Beam projector (installed)
- Banner size: 7.6 m X 0.6 m (magnet attachment)

· Specifications (303B)

- Audio system
- Built - in screen (150")
- Beam projector (installed)
- Banner size: 7.6 m X 0.55 m (magnet attachment)

▶ Meeting Room 304

Type	Area(m ²)	Width X Length X Height (m)	Theater	Banquet	Classroom
-	56	7,5 x 7,8 x 3,0	60	40	45

· Specifications

- Audio system
- Built - in screen (150")
- Beam projector (portable)
- Banner size: 7.6 m X 0.55 m (magnet attachment)

DELIZIA RESTAURANT

- ▶ Location 3th floor
- ▶ Major Function Restaurant, Banquets of various size
- ▶ Menu Buffet, Western, Korean, Traditional food of Jeju
- ▶ Seats 200
- ▶ Business Hours 11:00 ~ 15:00 (Lunch)
15:30 ~ 17:00 (Break Time)
17:00 ~ 21:00 (Dinner)
- ▶ Reservation and Contact +82-64-738-6400

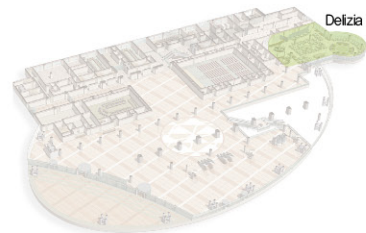

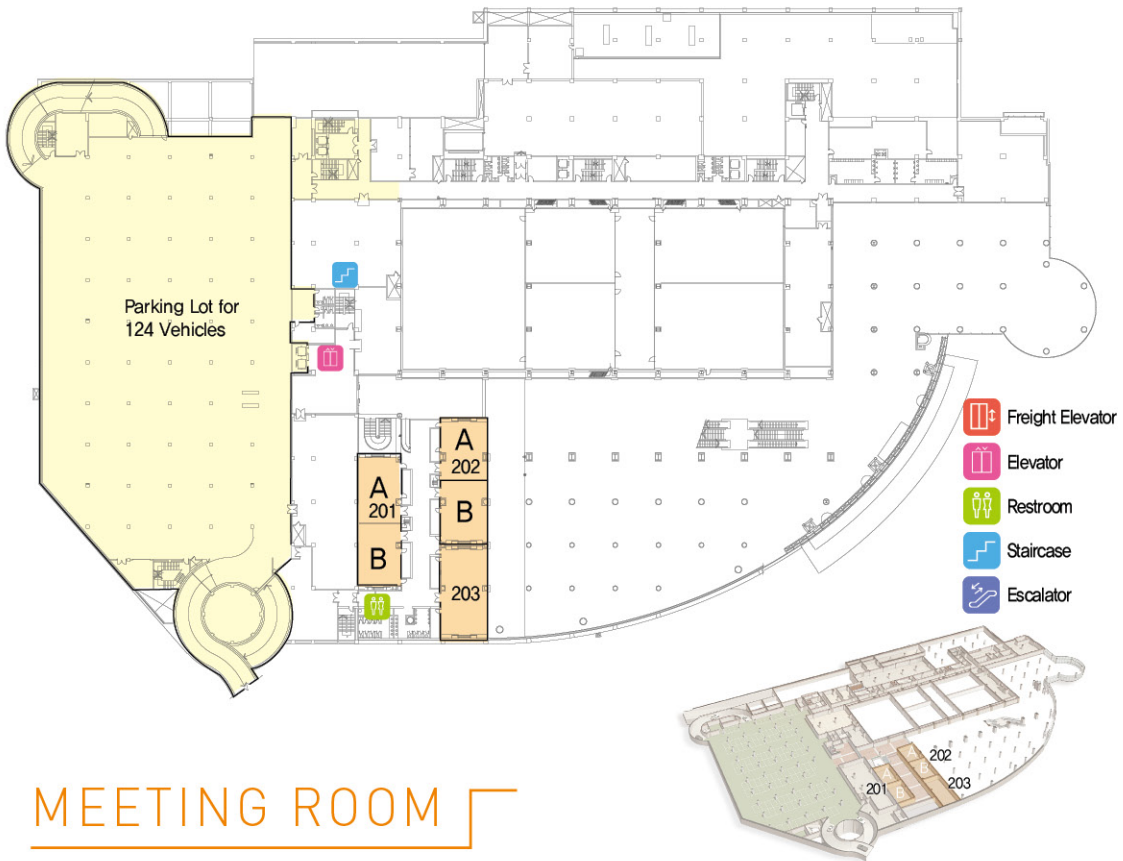

MEETING ROOM

Meeting Room 201 (2 sections)

Type	Area(m ²)	Width X Length X Height (m)	Theater	Banquet	Classroom
A + B	234	8,7 x 26,9 x 3,3	200	100	150
A	120	8,7 x 13,8 x 3,3	100	50	75
B	114	8,7 x 13,1 x 3,3	100	50	75

Specifications (201A)

- Audio system
- Built - in screen (180")
- Beam projector (installed)
- Banner size: 7.2m X 0.7m

Specifications (201B)

- Audio system
- Built - in screen (120")
- Beam projector (installed)
- Banner size: 7.2m X 0.7m

Meeting Room 202 (2 sections)

Type	Area(m ²)	Width X Length X Height (m)	Theater	Banquet	Classroom
A+B	237	9,5 x 25,5 x 3,3	200	100	150
A	117	9,5 x 12,8 x 3,3	100	50	75
B	120	9,5 x 12,7 x 3,3	100	50	75

Specifications (202A)

- Audio system
- Built - in screen (180")
- Beam projector (installed)
- Banner size: 9.3m X 0.7m

Specifications (202B)

- Audio system
- Built - in screen (120")
- Beam projector (installed)
- Banner size: 7.2m X 0.7m

Meeting Room 203

Type	Area(m ²)	Width X Length X Height (m)	Theater	Banquet	Classroom
203	174	9,5 x 18,5 x 3,3	150	80	100

Specifications

- Audio system
- Built - in screen (180")
- Beam projector (installed)
- Banner size: 9.3m X 0.7m





EVENT HALL

Located on the 1st floor, the Event Hall may be divided into three sections for multi-use, and it is available for various purposes such as exhibitions, seminars, banquets, and other events.

Type	Area(m ²)	Width X Length X Height (m)	Theater	Banquet	Classroom
A+B+C	2,395	75.55 x 31.8 x 6.1	2,450	1,510	1,830
A	772	24.40 x 31.8 x 6.1	790	490	590
B	811	25.20 x 31.8 x 6.1	830	510	620
C	812	25.55 x 31.8 x 6.1	830	510	620

Specifications

- Straight lamp for freight doorway (4m), Entrance of Event Hall (2.5m)
- Load Limit 2tons/m²
- 100 exhibition booths (3m X 3m / booth)
- Power (6 spots, 225 A)
- 60 ground trench distribution boxes (30 A)

Specifications (Event Hall A)

- Audio system
- Screen: 6m (horizontal)
- Beam projector (elevation)
- Banner size: 7.8m X 0.7m

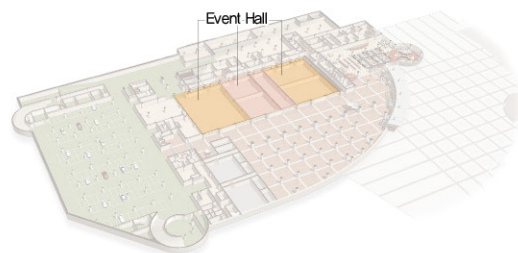

YEONGJU HALL · BAEKNOK HALL

▶ Yeongju Hall (2 sections)

Type	Area(m ²)	Width X Length X Height (m)	Theater	Banquet	Classroom
A+B	831	25.8 x 32.2 x 6.6	750	450	560
A	403	25.8 x 15.6 x 6.6	360	220	320
B	428	25.8 x 16.6 x 6.6	390	230	340

· Specifications

- Audio system
- Screen: 6 m (horizontal)
- Beam projector (elevation)
- Banner size: 7.8m X 0.7m

· Specifications (Yeongju A)

- Audio system
- Screen
- Beam projector (portable)
- Banner size: 6.8m X 0.7m

· Specifications (Yeongju B)

- Audio system
- Screen
- Beam projector (portable)
- Banner size: 6.8m X 0.7m

▶ Baeknok Hall (2 sections)

Type	Area(m ²)	Width X Length X Height (m)	Theater	Banquet	Classroom
A+B	596	18.5 x 32.2 x 6.6	500	300	420
A	289	18.5 x 15.6 x 6.6	240	140	200
B	307	18.5 x 16.6 x 6.6	260	160	220

· Specifications

- Audio system
- Screen: 6m (horizontal)
- Beam projector (elevation)
- Banner size: 7.8m X 0.7m

· Specifications (Baeknok A)

- Audio system
- Screen: 6m (horizontal)
- Beam projector (portable)
- Banner size: 7.8m X 0.7m

· Specifications (Baeknok B)

- Audio system
- Screen: 6m (horizontal)
- Beam projector (portable)
- Banner size: 7.8m X 0.7m

SORANG

- ▶ Location 1st floor
- ▶ Major Functions Banquets
- ▶ Menu Vary by prices
- ▶ Seats 150

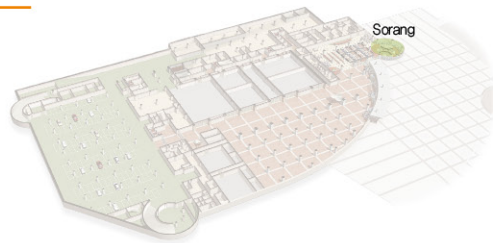

IEODO PLAZA

- ▶ Location 1st floor(outdoor)
- ▶ Area 3,375m²

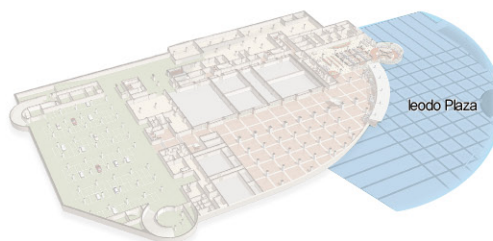

Dream of MICE

ICCJEJU



224 Jungmungwangwang-ro, Seogwipo, Jeju Special Self-Governing Province, 63547, Republic of Korea

Tel. +82-64-735-1000 Fax. +82-64-738-8988

Seoul Office

801&802, Liu Ma Building, Gonghang-daero, Gangseo-gu, Seoul, 07807, Republic of Korea

Tel. +82-2-775-1091~4 Fax. +82-2-775-1108

www.iccjeju.co.kr